



# MINI FIREFLY

## SPECIFICATIONS

base code	67241
typology	Garden projector
mounting	On ground with stem. Cable length 2000 mm / 78.7"
height	60° half snoot: 385 mm / 15.2" Standard: 350 mm / 13.8"
diameter	Fixture: 24 mm / 0.9". Stem: 6 mm / 0.2"
construction	Fixture: turning and milling aluminium. Lens in PMMA complete with silicone gasket. Flexible stem in composite fiberglass
finishes	Powder coated
ingress protection	IP66. North America: wet location
lamp type	LED on printed circuit board. Remote power supply not included
lamp wattage	1,5W at 24V DC
delivered lumens	40lm
lumen maintenance	50.000h L90
beam	16°, 36°, 45°. Honeycomb for visual comfort included
kelvin	2200K CRI80, 2700K CRI93, 3000K CRI93 / 3 step MacAdam ellipse
special features	Water Stop Technology. Safe Wiring. Two Wires Dimming. Reverse Polarity Protection
control protocols	0-10V, DMX or DALI
certifications	CE, ETL listed (certified to UL 2108, CSA C22.2)

60° HALF SNOOT

STANDARD

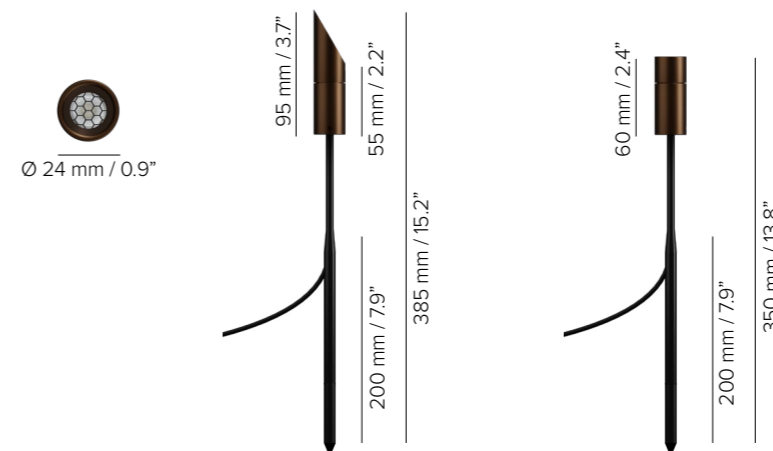

### SPECIAL FEATURE: WATER DRAINAGE SYSTEM

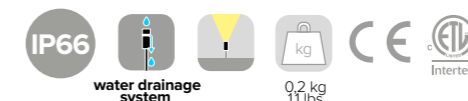
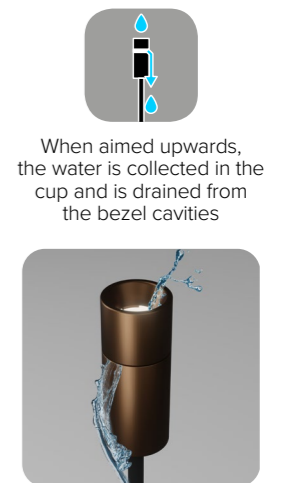

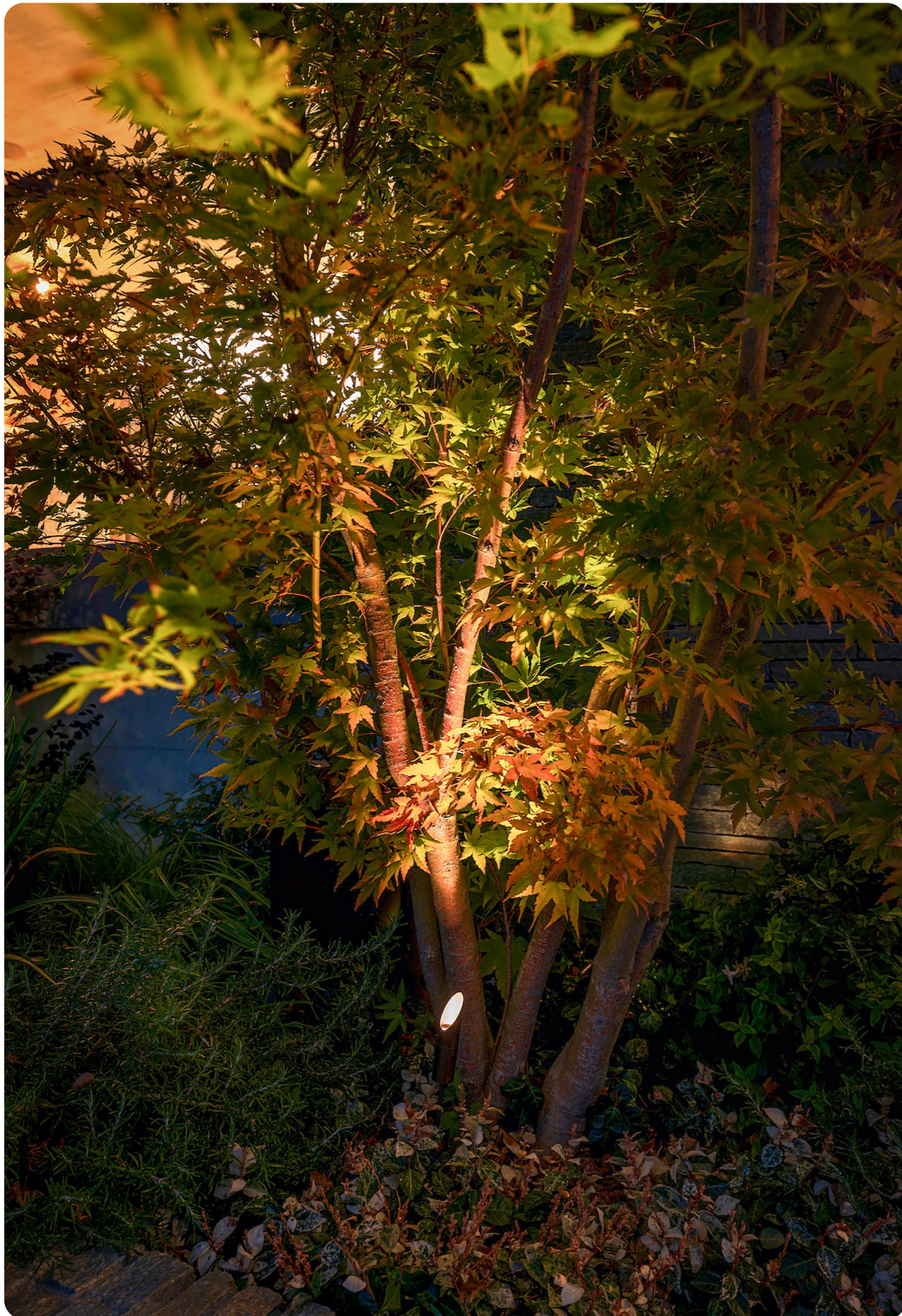

# MINI FIREFLY

## ORDER CODE

### BASE CODE

67241

### A . POWER SUPPLY

- 9 24V DC power supply NOT included
- R  listed 24V DC power supply NOT included

### B . KELVIN

- 5 3000K CRI93
- 8 2700K CRI93
- I 2200K CRI80

### C . BEAM

- 2 spot 16°
- 4 flood 36°
- 5 wide flood 55°



Example: **67241** BASE CODE A B C D E  
**9 8 4 F A** = **67241-984FA**

### D . FINISHES

- F golden bronze



### E . OTHER

- A 60° half snoot with honeycomb
- B Honeycomb



## ACCESSORIES

### REQUIRED ACCESSORIES - NOT INCLUDED

	code	output power	input voltage / frequency	IP	dimensions mm
Power supply 24V DC*, ON/OFF ambient temperature up to 60° C	69061	40W	90-305V 47-63Hz	IP67	L171xW62xH37
Power supply 24V DC*, DALI	69220	120W	90-305V 47-63Hz	IP65	L191xW63xH38
Power supply 24V DC*, 0-10V	69215	60W	90-305V 47-63Hz	IP65	L150xW53xH35
Class 2 power supply 24V DC*  listed	Consult <b>B LIGHT North America</b> Lighting Group Network T: 212.775.6363 E: info@lightinggroupnetwork.com				



code	description	dimensions mm
69842	IP68 connector, 1 IN - 1 OUT, 2 wires	W37xD22xH37
69847	IP68 connector, 1 IN - 3 OUT, parallel wiring, 2 wires	W45xD30xH17

\*To choose the power supply, always add a spare 20% as safety margin.  
 See pag 519 for cable size and max wiring distance from power supply to last connected luminaire